

SINCOTRON



eps SC-740

Stencil Cleaning System

eps SC-740

Overview

Two models available

Single Tank (ST) - Single tank for cleaning liquid

Double tank (DT) - Dual tanks for separate cleaning and rinsing liquids

Ideal for cleaning adhesive or solder paste stencils

Typical applications for double tank machine

Metal Stencil Cleaning

Pump Print Stencil Cleaning

Misprint Cleaning

PCBA Defluxing

Squeegee Cleaning

Screen Cleaning

Maintenance Part Cleaning

- Simple to use machine with Android based interactive user interface
- Versatile machine with closed loop systems for cleaning, rinsing (optional) and drying
- Separate spray pumps and filtration systems
- Vertical elevator mechanism mounted with synchronous Spray Arms and Air Knives
- Linear fluid delivery technology
- Low pressure spray nozzles with <1 bar for cleaning of sensitive screens and stencils
- Vertical elevator mechanism with adjustable stroke
- Simple cleaning, rinsing and drying process with user programmed parameters

Features

Air Knife

- Air knife fitted on each arm.
- Drying percentage and time is programmable.
- Air knives are fitted with heating elements and high velocity blowers with air filters.

Filters

- Two sequential 20um and 5um large diameter BB filters used for cleaning circuit.
- If cleaning filters become blocked, a filter jam alarm is displayed on the HMI.
- Additional 5um large diameter BB filter on rinsing circuit of dual tank system.

Draining Valve

- Drain Valve is present on each tank to drain all used liquids.

Complete Stainless Steel chamber and pipework

- Chamber, fluid tanks, spray arms and piping in the machine is fabricated in Stainless Steel.

Easy to handle Door with lock

- Simple mechanical open and close mechanism.
- Mandatory interlocked protection mechanism used.
- If door is opened whilst machine is running, system stops immediately.

Cleaning and rinsing liquid pumps

- Used to pump fluid from tank and spray through nozzles for cleaning or rinsing process.
- Separate pumps are used for two tank machine for cleaning and rinsing processes.
- Magnetically coupled pumps.

Liquid Level Indicator

- Liquid level indicators show current level of the liquid present in each tank.
- If current level is below or above acceptance level, an alarm is given on the HMI as well as on light tower.
- Machine will not start if liquid level is not within acceptable range.

HMI Facilities

- Easy to add and modify any program.
 - Storage up to 99 Programs.
 - Weekly Timer facility.
 - Password Protected setup and programs.
 - SPC fault monitoring and reporting facility.
 - Manual mode for testing inputs and outputs along with status.
-

Specification

Specification	Single Tank (ST)	Double Tank (DT)
Length (L-R)	950mm	950mm
Depth (F-B)	1250mm	1250mm
Height	1850mm	1850mm
Frame Dimension	740 x 740mm (29 x 29") max.	740 x 740mm (29 x 29") max.
Controller	10" Touchscreen with PLC	10" Touchscreen with PLC
Dry Weight	Approx. 350Kg	Approx. 360Kg
Voltage Supply	400V 3-Ø (3NPE) 50Hz	400V 3-Ø (3NPE) 50Hz
Cleaning Unit		
Wash Tank Volume	65 Litres	65 Litres
Pump	Magnetically Coupled Centrifugal	Magnetically Coupled Centrifugal
Filters	20 Micron & 5 Micron 10"LD	20 Micron & 5 Micron 10"LD
Heater	1 x 3kW Max. 60°C	1 x 3kW Max. 60°C
Nozzle Pressure	Approx. 0.9 Bar	Approx. 0.9 Bar
Typical Cycle Time	3 to 6 Minutes	3 to 6 Minutes
Rinsing Unit		
Rinse Tank Volume		32 Litres
Pump		Magnetically Coupled Centrifugal
Filters		5 Micron 10"LD
Nozzle Pressure		Approx. 0.55 Bar
Typical Cycle Time		2 Minutes
Drying Unit		
Centrifugal Blower with Air Knife	x 2	x 2
Heater	2 x 1.5kW Max. 85°C	2 x 1.5kW Max. 85°C
Typical Cycle Time	6 to 12 Minutes	6 to 12 Minutes

Cleaning frames

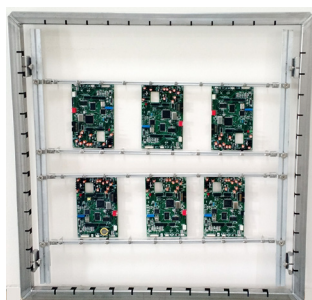

**Finger Bars for
PCB cleaning**

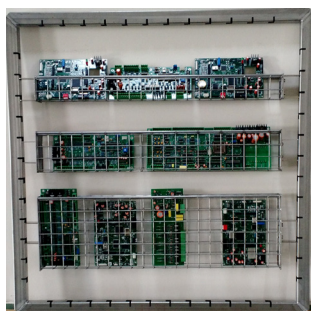

**Baskets for PCB
and Tool cleaning**

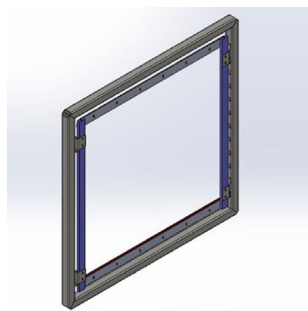

**Frame for VectorGuard
stencil cleaning**

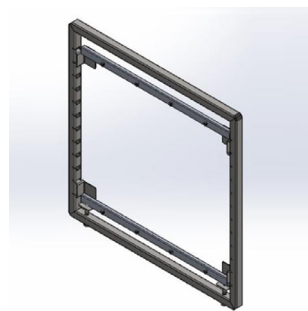

**Frame for Frameless
stencil cleaning**

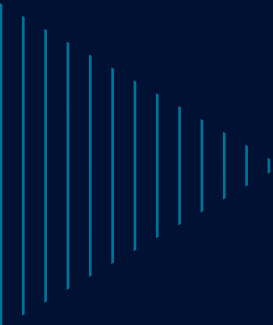

Sincotron Group

Kaluri tee 5
73001 Viimsi
Estonia

✉ desk@sincotron.eu
🌐 www.sincotron.eu